

THIS IS A C.A.D. GENERATED DRAWING  
DO NOT MAKE MANUAL REVISIONS TO MASTER.

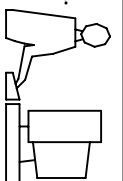

ISSUE NUMBER  
ORIGINAL

①

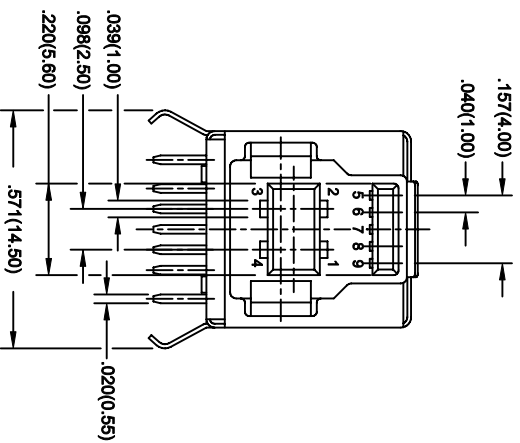
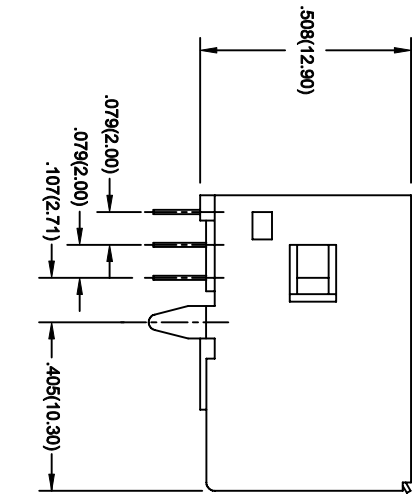
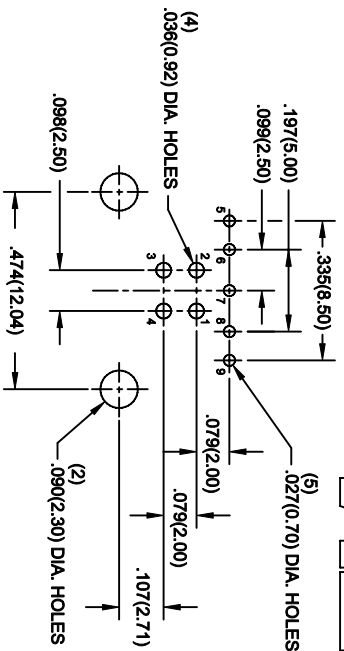
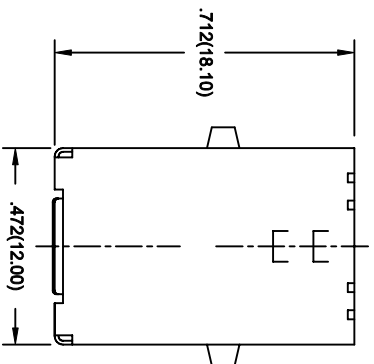

**ELECTRICAL SPECIFICATIONS:**

CURRENT RATING: 1 AMP, 30VAC  
CONTACT RESISTANCE: 30 MILLIOHMS MAX.  
INSULATION RESISTANCE: 1000 MEGOHMS MIN.  
DWM: 500VAC  
TEMPERATURE RATING: -50°C TO +105°C

**MATERIALS:**

HOUSING AND COVER: PBT 30%G.F. UL94V-0 COLOR BLACK  
CONTACTS: COPPER ALLOY, GOLD PLATED ON CONTACT AREA  
TIN ON TAILS OVER NICKEL  
SHELL: BRASS, NICKEL PLATED  
COVER SHELL: COPPER ALLOY, NICKEL PLATED

**GOLD PLATED PART NUMBERS**

690-009-521-900 15 MICRONS OF GOLD  
690-009-621-900 30 MICRONS OF GOLD

**USB-B RECEPTACLE 90° DIP, 3.0 VERSION**

ACAD REFERENCE NO. 690-009-221-900

DRAWN: F. BRIONES DATE: AUG. 17/09

PART NUMBER

**SEE GOLD PLATED P/N**

DRAWING NUMBER

**690-009-221-900**

ISSUE

**4**

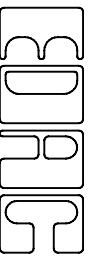

EDAC INC  
TORONTO, ONTARIO  
CANADA

YOUR CONNECTION TO QUALITY & SERVICE

THESE DRAWINGS AND SPECIFICATIONS  
ARE THE PROPERTY OF EDAC INC. AND  
SHALL NOT BE REPRODUCED OR COPIED  
OR USED AS THE BASIS FOR THE  
MANUFACTURE OR SALE OF APPARATUS  
WITHOUT WRITTEN PERMISSION.



THIS SERIES FULLY CONFORMS TO THE  
EUROPEAN UNION DIRECTIVES 2002/95/EC  
AND 2002/96/EC FOR RoHS COMPLIANCY.