

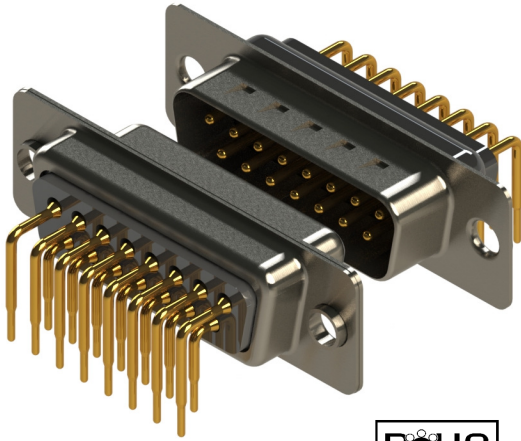

SERIES 621M/622M: D-SUB CONNECTOR

Plug and Receptacle, Right Angle, .283"(7.20mm) Footprint



- Two Contact Rows with .283"(7.20mm) Footprint Right Angle Bend D-Sub with Machined Contacts
- .109"(2.77mm) Contact Spacing x .112"(2.84mm) Row Spacing
- Plug and Receptacle in 9, 15, 25, 37 or 50 Contact Sizes
- Pin and Socket Contact Mating Design with P.C. Tail Termination
- Metal Shell Provides EMI/RFI Shielding, Plug Shell Indents provide Grounding and Additional Mating Retention
- Grounding Features include Ground Brackets with Four Prong Boardlock for Exceptional Retention to P.C. Board
- Mounting Options for Panel Mount or Connector Mating include Through Hole, Threaded Inserts and Threaded Standoffs
- Insulation Housing are offered in different colors, Black, White, Green and Blue
- D-Shaped Connector Mating Outline provides Polarization



Specifications:

Insulator Material	PA6T, UL 94V-0, Color: Black, White, Blue or Green
Contact Material	Precision Machined Copper Alloy
Contact Plating	Gold Plating over Nickel All Over
Shell Material	Nickel Plated Steel (Optional Tin Plating)
Current Rating	5A Per Contact
Contact Resistance	10 Milliohms MAX
Insulation Resistance	5000 Megohms MIN
Dielectric Voltage	1000V AC rms at Sea Level
Operating Temp.	-55°C To +125°C

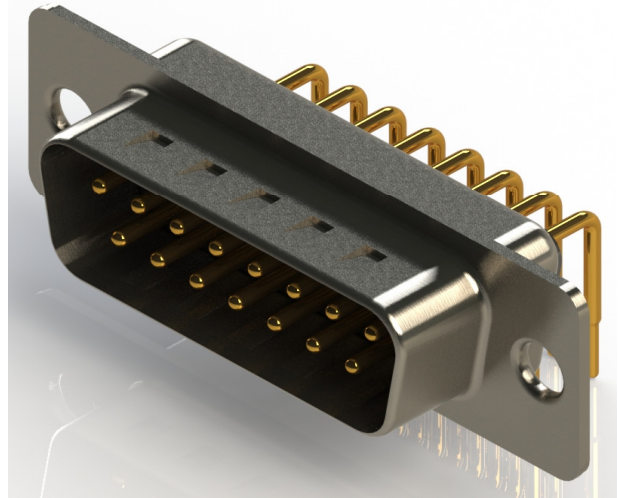

Ordering Code: 621-M25-260-BN3

SERIES: _____

621: PLUG (PIN)
622: RECEPTACLE (SOCKET)

M: MACHINED CONTACTS _____

NO. OF CONTACTS: _____

009 - 9 CONTACTS 025 - 25 CONTACTS
015 - 15 CONTACTS 037 - 37 CONTACTS
050 - 50 CONTACTS

CONTACT FINISH CODE: _____

2 - GOLD FLASH PLATING
3 - 15 MICROINCHES OF GOLD PLATING
6 - 30 MICROINCHES OF GOLD PLATING

CONTACT CODE: _____

60 - .283"(7.20MM) FOOTPRINT RIGHT ANGLE PC TAIL

MOUNTING & GROUNDING OPTIONS:

- 1 - Ø.120"(Ø3.05) THROUGH HOLE
- 2 - 4-40 UNC INSERT
- 3 - 4-40 UNC INSERT + STABILIZER PCB + BOARDLOCKS
- 4 - 4-40 UNC INSERT + STABILIZER PCB + Ø.126"(Ø3.20) HOLE
- 5 - 4-40 UNC STANDOFF + STABILIZER PCB + BOARDLOCKS
- 6 - 4-40 UNC STANDOFF + STABILIZER PCB + Ø.126"(Ø3.20) HOLE

SHELL PLATING CODE:

N - NICKEL
T - TIN

HOUSING MATERIAL CODE:

B - BLACK
W - WHITE
G - GREEN
L - BLUE



SERIES 621M/622M: D-SUB CONNECTOR

Plug and Receptacle, Right Angle, .283"(7.20mm) Footprint

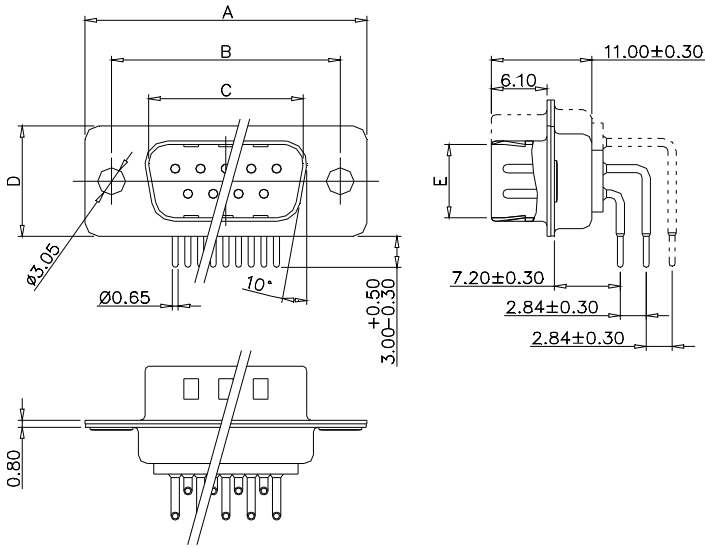

PLUG

No. of Pos.	A	B	C	D	E
09	30.80	25.00	16.90	12.50	8.30
15	39.20	33.30	25.25	12.50	8.30
25	53.05	47.05	38.95	12.50	8.30
37	69.40	63.50	55.40	12.50	8.30
50	67.00	61.00	52.80	15.30	11.15

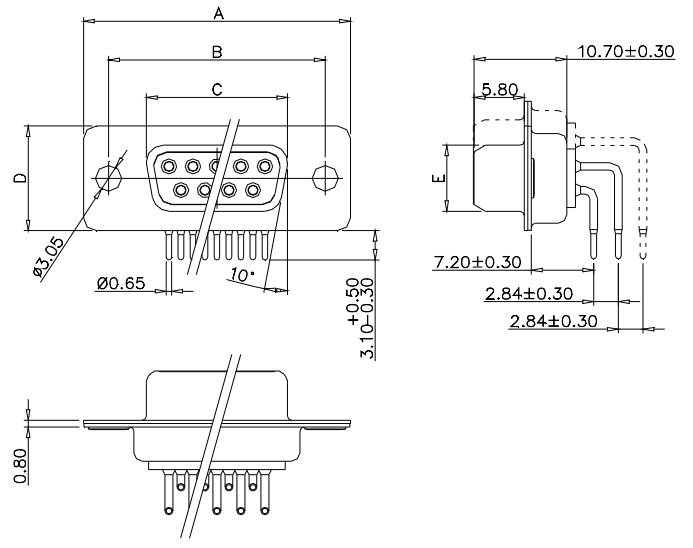

RECEPTACLE

No. of Pos.	A	B	C	D	E
09	30.80	25.00	16.30	12.50	7.90
15	39.20	33.30	24.60	12.50	7.90
25	53.05	47.05	38.40	12.50	7.90
37	69.40	63.50	54.80	12.50	7.90
50	67.00	61.00	52.20	15.30	10.90

MOUNTING & GROUNDING OPTIONS:

CODE - 1

Ø3.05 THROUGH HOLE

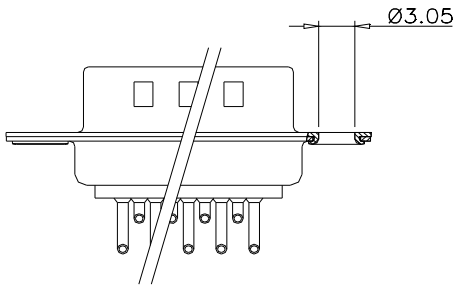

CODE - 2

#4-40 UNC INSERT

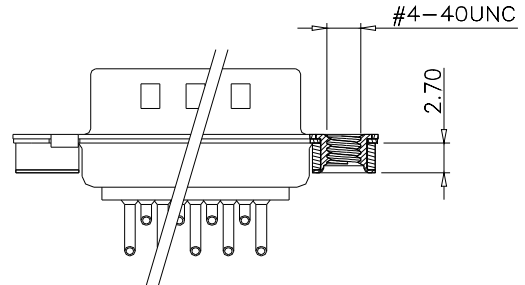

CODE - 3

#4-40 UNC INSERT + STABILIZER PCB + BOARDLOCKS

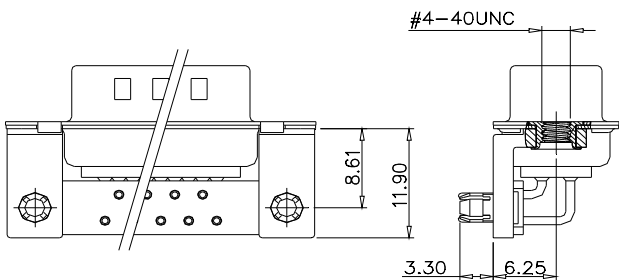

CODE - 4

#4-40 UNC INSERT + STABILIZER PCB + Ø3.20 HOLE

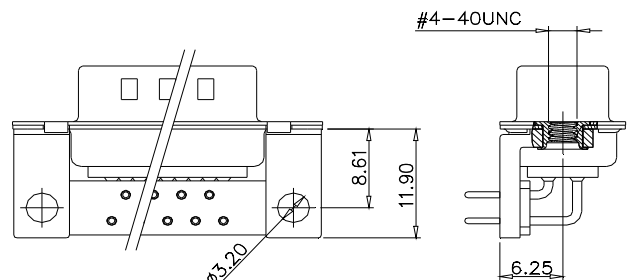



SERIES 621M/622M: D-SUB CONNECTOR

Plug and Receptacle, Right Angle, .283" (7.20mm) Footprint

MOUNTING & GROUNDING OPTIONS:

CODE - 5

#4-40 UNC STANDOFF + STABILIZER PCB + BOARDLOCKS

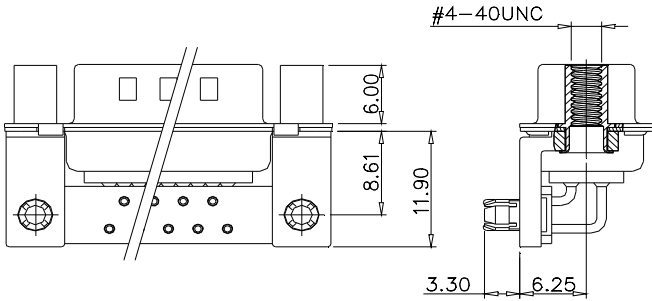

CODE - 6

#4-40 UNC STANDOFF + STABILIZER PCB + $\varnothing 3.20$ HOLE

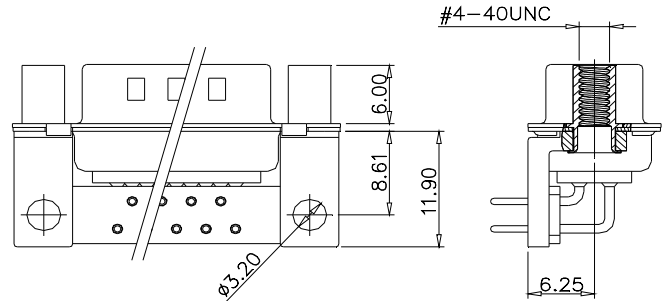

RECOMMENDED PCB LAYOUT

9 POS

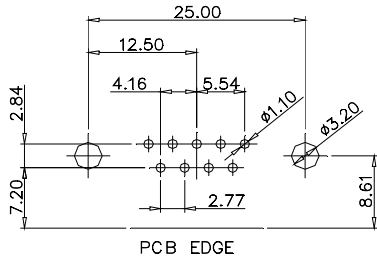

37 POS

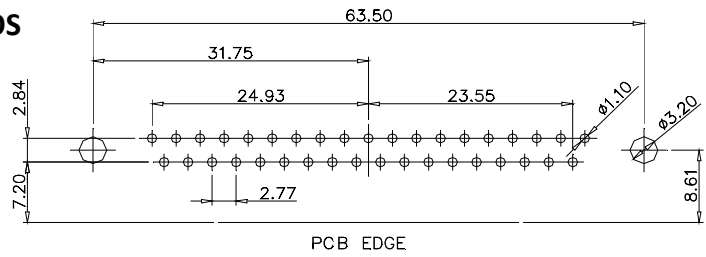

15 POS

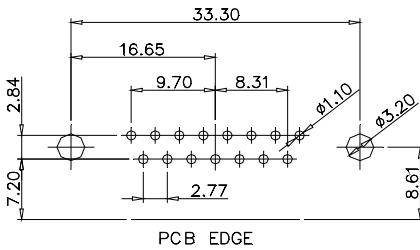

50 POS

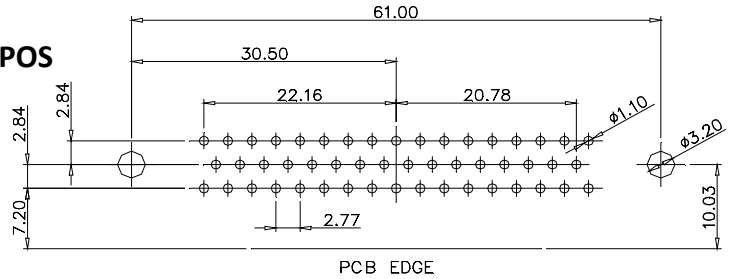

25 POS

